

OREGON CORNER RECONSTRUCTION FORM

Section 28 Township 2N Range 27E
 County Umatilla Date: February 27, 2006

Corner Designation: 2N27T13

Common quarter corner to sections 27 and 28, T2N, R27E,
 W.M., Umatilla County, Oregon.

Condition Report Only
 Not found
 Remonumented
 Unrecorded
 Surveyed in
 Referenced out

Previous Renewals / Surveys, etc.

Corner originally set by Ebenezer E. Haft in survey approved December 31, 1860. His record reads: Set a post on bank of Butter Creek in mound for qr. sec. corner with trench and pits and deposited 1 pint of charcoal as per instructions. Wayne Harris set a 2" Iron Pipe under Umatilla County Survey Q-1300-A in 1958. I found no other record of monumentation at this corner.

Monument and Accessories found: (condition and source)

None. The point falls in a field access road between the creek and an irrigation ditch.

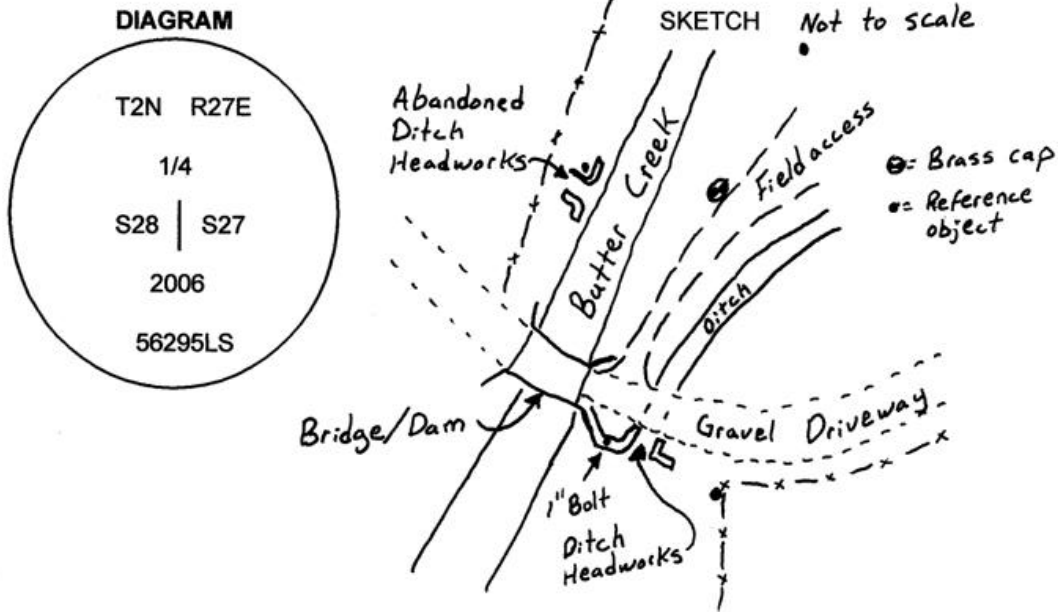

MONUMENT (S) AND ACCESSORIES SET (Procedures and Description)

I set a 1 1/2" x 30" galvanized iron pipe with a 2 1/4" brass cap stamped as shown in the diagram above at the average intersection of fences North, West and South.

For references, I set three 5/8" by 24" rebars with 2.5" orange plastic caps stamped WTS and 56295LS as described below:

- an iron rebar bears N39°40'23"E, 70.87 feet;
- an iron rebar bears S76°26'16"W, 74.87 feet;
- an iron rebar bears S00°10'27"W, 96.63 feet;
- a 1" iron bolt in the SE corner of a concrete bridge bears S43°19'12"W, 104.05 feet;

The monument and references were tied using a Trimble R7/R8 RTK GPS.

Location and comments

Compass Declination

Surveyors Seal

RECEIVED BY:
Umatilla County Surveyor
 Date: 3/15/06
 Rec'd By: J. Roberts
 No. 06-039-B

Firm / Agency
 Witness Tree Surveying
 Address
 P.O. Box G
 Pilot Rock, Or. 97868
 Surveyor
 Stephen K, Haddock